

Setscrew Ball Bearings

SCM MEDIUM DUTY 4-BOLT FLANGE BEARINGS

Lube Fitting Thread Size:
 203 - 204 series - 1/4-28 tapered thread
 207 - 207 series - 1/8-27 NPT

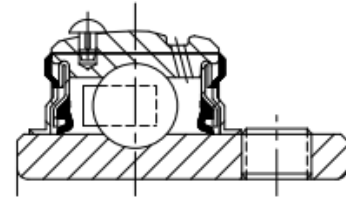
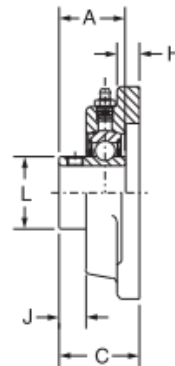
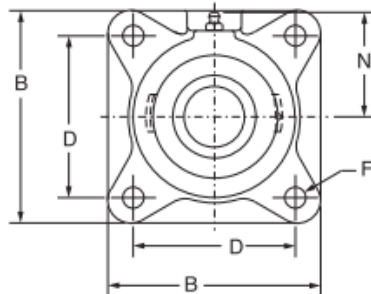

| Series | Shaft Size | Standard | | No-Lube/Sealed for Life (-NL) | |
|--------|------------|----------|-------------|-------------------------------|----------------|
| | | Part No. | Description | Part No. | Description |
| 206 | 1 | 126226 | F4B-SCM-100 | 052017 | F4B-SCM-100-NL |
| | 25mm | 125965 | F4B-SCM-25M | @ | F4B-SCM-25M-NL |
| 207 | 1-3/16 | 126227 | F4B-SCM-103 | 056907 | F4B-SCM-103-NL |
| | 1-1/4 | 124206 | F4B-SC-104 | 126528 | F4B-SC-104-NL |
| | 30mm | 125966 | F4B-SCM-30M | @ | F4B-SCM-30M-NL |
| 208 | 1-7/16 | 126187 | F4B-SCM-107 | 062842 | F4B-SCM-107-NL |
| | 35mm | 125967 | F4B-SCM-35M | @ | F4B-SCM-35M-NL |
| 209 | 1-1/2 | 126188 | F4B-SCM-108 | 062897 | F4B-SCM-108-NL |
| | 1-5/8 | 125170 | F4B-SC-110L | @ | F4B-SC-110L-NL |
| | 40mm | 125968 | F4B-SCM-40M | @ | F4B-SCM-40M-NL |
| 210 | 1-11/16 | 126189 | F4B-SCM-111 | 065576 | F4B-SCM-111-NL |
| | 1-3/4 | 126190 | F4B-SCM-112 | @ | F4B-SCM-112-NL |
| | 45mm | 125969 | F4B-SCM-45M | @ | F4B-SCM-45M-NL |
| 211 | 1-15/16 | 126191 | F4B-SCM-115 | 052302 | F4B-SCM-115-NL |
| | 2 | 126192 | F4B-SCM-200 | 052004 | F4B-SCM-200-NL |
| | 50mm | 125970 | F4B-SCM-50M | 073950 | F4B-SCM-50M-NL |
| 212 | 2-3/16 | 126193 | F4B-SCM-203 | 052003 | F4B-SCM-203-NL |
| | 2-1/4 | 126283 | F4B-SCM-204 | 126537 | F4B-SCM-204-NL |
| | 55mm | 125971 | F4B-SCM-55M | @ | F4B-SCM-55M-NL |
| 214 | 2-7/16 | 126194 | F4B-SCM-207 | 052002 | F4B-SCM-207-NL |
| | 2-1/2 | 126195 | F4B-SCM-208 | 065653 | F4B-SCM-208-NL |
| | 65mm | 125972 | F4B-SCM-65M | @ | F4B-SCM-65M-NL |
| 215 | 2-11/16 | 126186 | F4B-SCM-211 | 052205 | F4B-SCM-211-NL |
| | 70mm | 125973 | F4B-SCM-70M | @ | F4B-SCM-70M-NL |
| 216 | 2-15/16 | 126196 | F4B-SCM-215 | 126538 | F4B-SCM-215-NL |
| | 3 | 126197 | F4B-SCM-300 | 126539 | F4B-SCM-300-NL |
| | 75mm | 125974 | F4B-SCM-75M | @ | F4B-SCM-75M-NL |
| 218 | 3-7/16 | 126198 | F4B-SCM-307 | 126540 | F4B-SCM-307-NL |
| | 3-1/2 | 126199 | F4B-SCM-308 | 126541 | F4B-SCM-308-NL |
| | 85mm | 125975 | F4B-SCM-85M | @ | F4B-SCM-85M-NL |

| Series | Shaft Size | Weight lbs. kgs. | A | B | C | D | F | H | J | L | N |
|--------|---------------|------------------|------|-------|------|-------|------|------|------|-------|-------|
| 206 | 1 | 3.0 | 1.52 | 4.25 | 1.56 | 3.25 | 7/16 | 0.50 | 0.49 | 1.57 | 2.19 |
| | 25mm | 1.3 | 38.6 | 108.0 | 39.6 | 82.6 | M10 | 12.7 | 12.4 | 39.9 | 55.6 |
| 207 | 1-3/16 | 4.1 | 1.71 | 4.75 | 1.75 | 3.63 | 1/2 | 0.56 | 0.53 | 1.84 | 2.44 |
| | 1-1/4 30mm | 4.0 1.4 | 43.4 | 120.7 | 44.5 | 92.1 | M12 | 14.2 | 13.5 | 46.7 | 62.0 |
| 208 | 1-7/16 | 5.0 | 1.94 | 5.13 | 1.98 | 4.00 | 1/2 | 0.56 | 0.63 | 2.05 | 2.38 |
| | 35mm | 2.1 | 49.3 | 130.3 | 50.3 | 101.6 | M12 | 14.2 | 16.0 | 52.1 | 60.5 |
| 209 | 1-1/2 | 6.1 | 1.94 | 5.38 | 1.99 | 4.13 | 1/2 | 0.63 | 0.59 | 2.22 | 2.75 |
| | 1-5/8 | 6.1 | | | | | | | | | |
| | 40mm | 2.7 | 49.3 | 136.7 | 50.5 | 104.8 | M12 | 16.0 | 15.0 | 56.4 | 69.9 |
| 210 | 1-11/16 | 7.1 | 1.94 | 5.63 | 2.02 | 4.38 | 1/2 | 0.63 | 0.55 | 2.43 | 2.88 |
| | 1-3/4 | 6.9 | | | | | | | | | |
| | 45mm | 3.0 | 49.3 | 143.0 | 51.3 | 111.1 | M12 | 16.0 | 14.0 | 61.7 | 73.2 |
| 211 | 1-15/16 | 9.5 | 2.22 | 6.50 | 2.28 | 5.13 | 5/8 | 0.69 | 0.68 | 2.71 | 3.25 |
| | 2 | 9.3 | | | | | | | | | |
| | 50mm | 4.1 | 56.4 | 165.1 | 57.9 | 130.2 | M16 | 17.5 | 17.3 | 68.8 | 82.6 |
| 212 | 2-3/16 | 11.3 | 2.31 | 6.88 | 2.38 | 5.63 | 5/8 | 0.69 | 0.66 | 2.97 | 3.50 |
| | 2-1/4 | 11.1 | | | | | | | | | |
| | 55mm | 6.0 | 58.7 | 174.8 | 60.5 | 142.9 | M16 | 17.5 | 16.8 | 75.4 | 88.9 |
| 214 | 2-7/16 | 16.2 | 2.54 | 7.38 | 2.78 | 5.88 | 5/8 | 0.69 | 0.60 | 3.31 | 3.69 |
| | 2-1/2 | 16.0 | | | | | | | | | |
| | 65mm | 7.3 | 64.5 | 187.5 | 70.6 | 149.2 | M16 | 17.5 | 15.2 | 84.1 | 93.7 |
| 215 | 2-11/16 | 18.3 | 2.33 | 7.75 | 2.88 | 6.00 | 3/4 | 1.00 | 0.63 | 3.62 | 3.88 |
| | 70mm | 8.0 | 59.2 | 196.9 | 73.2 | 152.4 | M18 | 25.4 | 16.0 | 91.9 | 98.6 |
| 216 | 2-15/16 | 21.5 | 2.38 | 7.75 | 3.09 | 6.00 | 3/4 | 0.88 | 0.59 | 3.83 | 4.09 |
| | 3 | 21.2 | | | | | | | | | |
| | 75mm | 9.4 | 60.5 | 196.9 | 78.5 | 152.4 | M18 | 22.4 | 15.0 | 97.3 | 103.9 |
| 218 | 3-7/16 | 28.0 | 2.56 | 8.44 | 3.38 | 6.75 | 3/4 | 1.00 | 0.60 | 4.35 | 4.63 |
| | 3-1/2 | 27.4 | | | | | | | | | |
| | 85mm | 12.2 | 65.0 | 214.4 | 85.9 | 171.5 | M18 | 25.4 | 15.2 | 110.5 | 117.6 |