

RUBBER CUSHIONED PRESSED STEEL PILLOW BLOCKS

RPB ECCENTRIC LOCKING COLLAR TYPE RPB S SET SCREW LOCKING TYPE

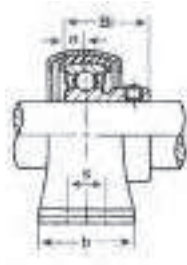

RPB S

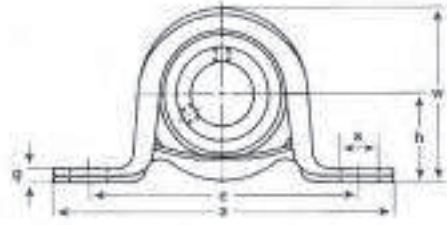

RPB

- Conductive rubber interliner
- Used to dissipate static and reduce noise and vibration

RPB ECCENTRIC LOCKING COLLAR TYPE

Unit No.	Shaft Dia. d (in.)	Dimension (in)										Bolt Size (in)	Bearing No.	Housing No.	Weight (lb)
		h	a	e	b	s	g	w	L	n	K				
RPB-8 RPB-10	1/2 5/8	1	3-7/8	3	1-1/4	23/64	3/32	1-31/32	1.1260	0.256	1-1/8	5/16	RABR-8 RABR-10	PP204	0.46
RPB-12	3/4	1-1/8	4-1/4	3-3/8	1-1/4	7/16	1/8	2-7/32	1.2205	0.295	1-1/4	3/8	RABR-12	PP205	0.70
RPB-14 RPB-15 RPB-16	7/8 15/16 1	1-5/16	4-5/8	3-3/4	1-1/2	7/16	5/32	2-19/32	1.2205	0.295	1-1/2	3/8	RABR-14 RABR-15 RABR-16	PP206	0.97
RPB-18 RPB-19 RPB-20	1-1/8 1-3/16 1-1/4	1-9/16	5-1/16	4-3/16	1-5/8	7/16	3/16	3-1/16	1.4055	0.354	1-3/4	3/8	RABR-18 RABR-19 RABR-20	PP207	1.21

RPB S SET SCREW LOCKING TYPE

Unit No.	Shaft Dia. d (in.)	Dimension (in)										Bolt Size (in)	Bearing No.	Housing No.	Weight (lb)
		h	a	e	b	s	g	w	Bi	n					
RPB-8S RPB-10S	1/2 5/8	1	3-7/8	3	1-1/4	23/64	3/32	1-31/32	0.8661	0.236	5/16	RABR-8S RABR-10S	PP204	0.37	
RPB-12S	3/4	1-1/8	4-1/4	3-3/8	1-1/4	7/16	1/8	2-7/32	0.9843	0.275	3/8	RABR-12S	PP205	0.58	
RPB-14S RPB-15S RPB-16S	7/8 15/16 1	1-5/16	4-5/8	3-3/4	1-1/2	7/16	5/32	2-19/32	1.0630	0.295	3/8	RABR-14S RABR-15S RABR-16S	PP206	0.77	
RPB-18S RPB-19S RPB-20S	1-1/8 1-3/16 1-1/4	1-9/16	5-1/16	4-3/16	1-5/8	7/16	3/16	3-1/16	1.1811	0.315	3/8	RABR-18S RABR-19S RABR-20S	PP207	1.06	

