

This deep groove, Conrad construction bearing is specifically designed to provide maximum performance by means of precise ball complement selection. The honed raceways offer a perfectly balanced bearing capable of operating under straight radial, thrust or combination loads. This series is available with shields, Buna N seals, or locating rings. Sealed bearings may be obtained with either low or high starting torques. Consult Peer's engineering staff for proper selection. Stainless steel 440C material is available upon request. Radial clearance is selected in accordance with applications ranging from C2 - C0 - C3 - C4 fits.

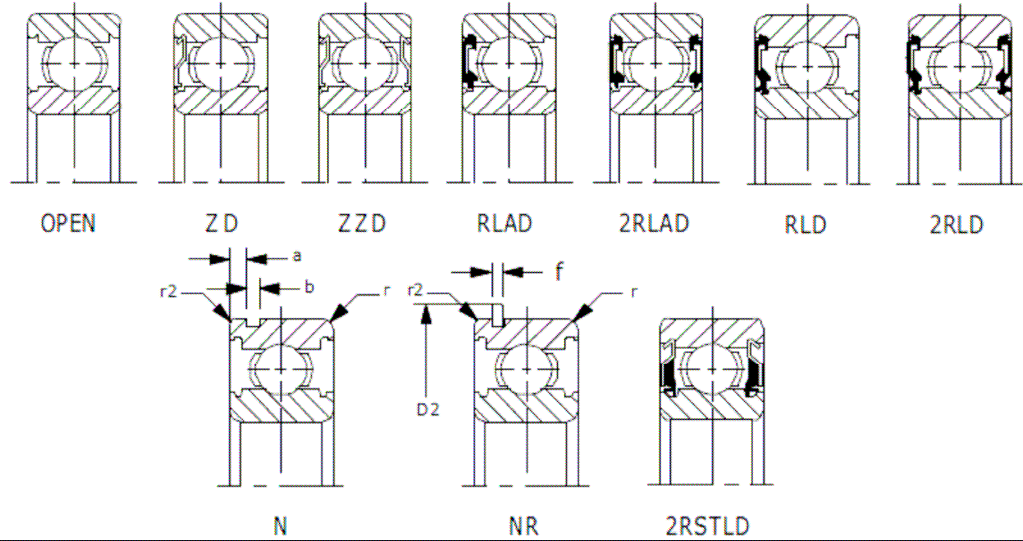
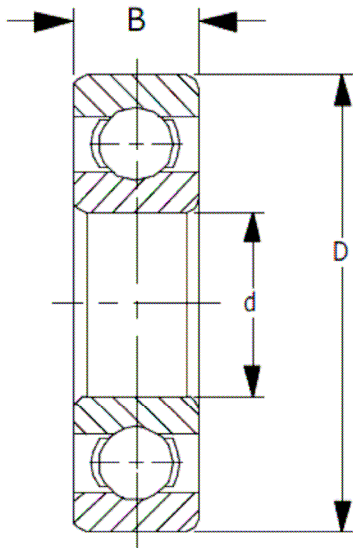

Units: Inches  
Metric

Part Number	Bore d	Tolerance +.0000 to minus	OD D	Tolerance +.0000 to minus	Width B	Tolerance +.0000 to minus	* fillet radii		snap ring dimensions		snap ring groove dimensions		Basic Load Ratings lbf N		Weight lb Kg	Limiting speed of Open Bearing (rpm)	
							r	r2	D2 Max	f Max	a Max	b Min	Dynamic Cr	Static Cor		oil	grease
99502H	.6250	.0003	1.375	.0005	.4331	.0047	.024	.020	1.563	.044	.081	.053	1,740	839	.110	26,000	20,000
	15.875	.008	34.93	.011	11	.120	.6	.5	39.7	1.12	2.06	1.35	7,740	3,732	.050		
499502H	.6250	.0003	1.375	.0005	.4331	.0047	.024	.020	1.563	.044	.081	.053	1,740	839	.110	26,000	20,000
	15.875	.008	34.93	.011	11	.120	.6	.5	39.7	1.12	2.06	1.35	7,740	3,732	.050		