

EPT E CATALOG - PART DETAIL

Browning 2B5V56

Cast Iron, 2 Groove, A, B or 5V Belt, Split Taper Sheave, Uses B Bushing



Images may not be an exact representation of the product

Product Type:	Split Taper Sheave
Type of Belt:	A, B, 5V
Number of Grooves:	2
Bore (Min):	0.5
Bore (Max):	2.4375
Bushing Used:	B

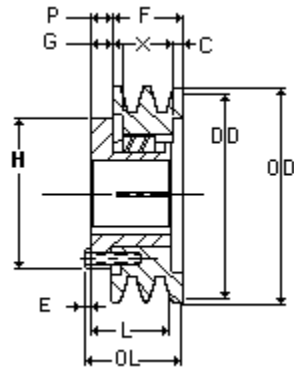

Part No	Description	PD (5V)	PD (A)	DD (A)	PD (B)	DD (B)
3693934	2B5V56	5.7	5.4	5.2	5.9	5.6
OL	OD	F	L	P	C	X
2.546875	5.88	1.71875	1.9375	0.625	0.234375	1.25
G	E	H				
0.859375	0.203125	3.6875				