

EPT E CATALOG - PART DETAIL

Browning 2B5V62

Cast Iron, 2 Groove, A, B or 5V Belt, Split Taper Sheave, Uses B Bushing



Images may not be an exact representation of the product

| | |
|---------------------------|--------------------|
| Product Type: | Split Taper Sheave |
| Type of Belt: | A, B, 5V |
| Number of Grooves: | 2 |
| Bore (Min): | 0.5 |
| Bore (Max): | 2.4375 |
| Bushing Used: | B |

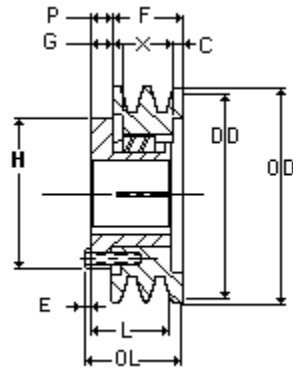

| Part No | Description | PD (5V) | PD (A) | DD (A) | PD (B) | DD (B) |
|-----------|-------------|----------|----------|----------|----------|----------|
| 3693967 | 2B5V62 | 6.3 | 6 | 5.8 | 6.5 | 6.2 |
| OL | OD | F | L | P | C | X |
| 2.546875 | 6.48 | 1.71875 | 1.9375 | 0.625 | 0.140625 | 1.34375 |
| G | E | H | | | | |
| 0.859375 | 0.203125 | 3.6875 | | | | |