

# EPT E CATALOG - PART DETAIL

## Browning 2TB42

Cast Iron, 2 Groove, A or B Belt, Split Taper Sheave, Uses P1 Bushing



*Images may not be an exact representation of the product*

<b>Product Type:</b>	Split Taper Sheave
<b>Type of Belt:</b>	A, B
<b>Number of Grooves:</b>	2
<b>Bore (Min):</b>	0.5
<b>Bore (Max):</b>	1.75
<b>Bushing Used:</b>	P1

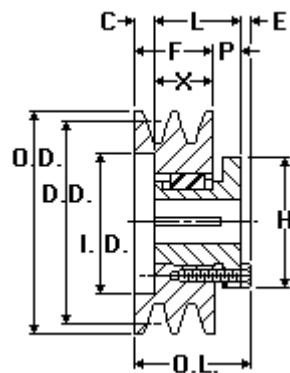

Part No	Description	PD (A)	DD (A)	PD (B)	DD (B)	OL
1001437	2TB42	4	3.8	4.5	4.2	2.578125
<b>OD</b>	<b>F</b>	<b>L</b>	<b>P</b>	<b>C</b>	<b>X</b>	<b>E</b>
4.55	1.75	1.9375	0.625	0.4375	1.3125	0.203125
<b>H</b>						
3						