

# EPT E CATALOG - PART DETAIL

## Browning 3B5V62

Cast Iron, 3 Groove, A, B or 5V Belt, Split Taper Sheave, Uses B Bushing



*Images may not be an exact representation of the product*

<b>Product Type:</b>	Split Taper Sheave
<b>Type of Belt:</b>	A, B, 5V
<b>Number of Grooves:</b>	3
<b>Bore (Min):</b>	0.5
<b>Bore (Max):</b>	2.4375
<b>Bushing Used:</b>	B

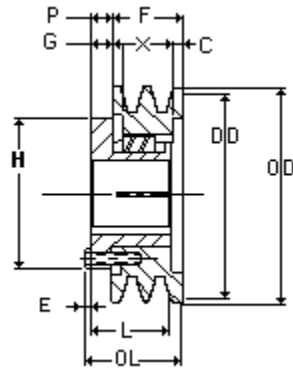

Part No	Description	PD (5V)	PD (A)	DD (A)	PD (B)	DD (B)
3694247	3B5V62	6.3	6	5.8	6.5	6.2
<b>OL</b>	<b>OD</b>	<b>F</b>	<b>L</b>	<b>P</b>	<b>C</b>	<b>X</b>
2.90625	6.48	2.4375	1.9375	0.265625	0.59375	1.25
<b>G</b>	<b>E</b>	<b>H</b>				
0.859375	0.203125	3.6875				