

EPT E CATALOG - PART DETAIL

Browning 3TB34

Cast Iron, 3 Groove, A or B Belt, Split Taper Sheave, Uses P2 Bushing



Images may not be an exact representation of the product

Product Type:	Split Taper Sheave
Type of Belt:	A, B
Number of Grooves:	3
Bore (Min):	0.75
Bore (Max):	1.75
Bushing Used:	P2

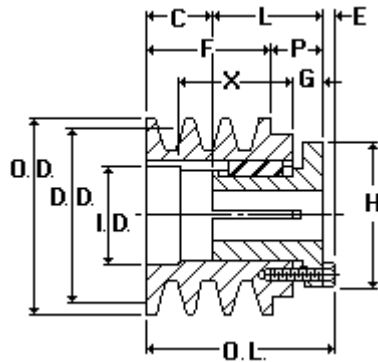

Part No	Description	PD (A)	DD (A)	PD (B)	DD (B)	OL
1001205	3TB34	3.2	3	3.7	3.4	3.890625
OD	F	L	P	C	X	G
3.75	2.5	2.9375	1.1875	0.75	2.3125	0.625
E	H					
0.203125	3					