

# EPT E CATALOG - PART DETAIL

## Browning 3TB56

Cast Iron, 3 Groove, A or B Belt, Split Taper Sheave, Uses P1 Bushing



*Images may not be an exact representation of the product*

<b>Product Type:</b>	Split Taper Sheave
<b>Type of Belt:</b>	A, B
<b>Number of Grooves:</b>	3
<b>Bore (Min):</b>	0.5
<b>Bore (Max):</b>	1.75
<b>Bushing Used:</b>	P1

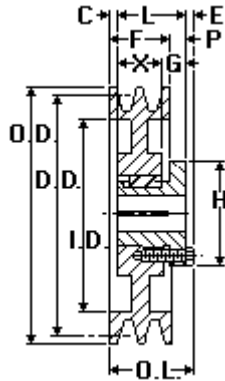

Part No	Description	PD (A)	DD (A)	PD (B)	DD (B)	OL
1001866	3TB56	5.4	5.2	5.9	5.6	2.703125
<b>OD</b>	<b>F</b>	<b>L</b>	<b>P</b>	<b>C</b>	<b>X</b>	<b>G</b>
5.95	2.5	1.9375	0	0.5625	1.3125	0.625
<b>E</b>	<b>H</b>					
0.203125	3					