

# EPT E CATALOG - PART DETAIL

## Browning AK30X5/8

Finished Bore Sheave, 5/8" Bore, Uses 3L, A Belt, 1 Groove

<b>Product Type:</b>	Finished Bore Sheave
<b>Type of Belt:</b>	3L, A
<b>Number of Grooves:</b>	1
<b>Warning:</b>	Do not use these "AK" sheaves with bores 1" and under with gripnotch belt ratings.
<b>Material:</b>	Cast Iron
<b>Typical Applications:</b>	
<b>Feature 1:</b>	Largest Selection of finished bore sheaves of any other manufacturer - Browning offers finished bore sheaves in both A & B Combination (A/B) configuration. 1, 2 & 3 Grooves are available to meet any fractional horsepower requirement.



*Images may not be an exact representation of the product*

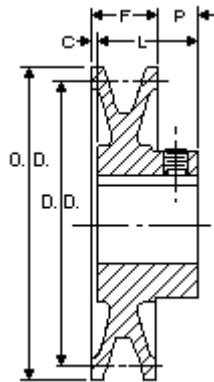

Part No	Description	Bore	D.D. (A)	PD (A)	D.D. (3L)	C
1026186	AK30X5/8	5/8	2.80	3.0	2.46	5/32
<b>F</b>	<b>P</b>	<b>L</b>	<b>O.D.</b>			
21/32	7/16	15/16	3.05			