

EPT E CATALOG - PART DETAIL

Browning AK32H

Bushed Classical Gripbelt Sheave, 4L or A, 3L Belt, 1 Groove, Uses H Bushing

| | |
|------------------------------|---------------------------|
| Product Type: | Classical Gripbelt Sheave |
| Type of Belt: | 4L or A, 3L |
| Number of Grooves: | 1 |
| Type of Bore: | Bushed |
| Bore (Min): | 3/8 |
| Bore (Max): | 1 1/2 |
| Typical Applications: | |



Images may not be an exact representation of the product

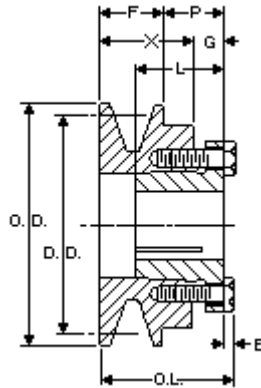

| Part No | Description | PD (A) | DD (A) | PD (3L) | E | F |
|---------|-------------|--------|--------|---------|--------|-----|
| 1042084 | AK32H | 3.2 | 3 | 2.66 | 5/32 | 3/4 |
| G | L | P | OD | OL | X | |
| 15/32 | 1 9/32 | 29/32 | 3.25 | 1 13/16 | 1 3/16 | |