

# EPT E CATALOG - PART DETAIL

## Browning BK27X7/8

Finished Bore Sheave, 7/8" Bore, Uses A, B Belt, 1 Groove

<b>Product Type:</b>	Finished Bore Sheave
<b>Type of Belt:</b>	A, B
<b>Number of Grooves:</b>	1
<b>Warning:</b>	Do not use these "BK" sheaves with "B" Gripnotch Belt ratings.
<b>Material:</b>	Cast Iron
<b>Feature 1:</b>	Largest Selection of finished bore sheaves of any other manufacturer - Browning offers finished bore sheaves in both A & B Combination (A/B) configuration. 1, 2 & 3 Grooves are available to meet any fractional horsepower requirement.



*Images may not be an exact representation of the product*

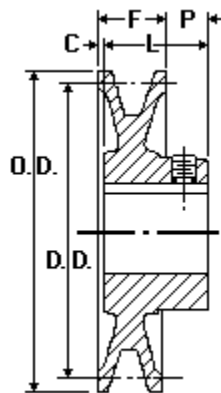

Part No	Description	Bore	D.D. (A)	PD (A)	D.D. (B)	PD (B)
1027945	BK27X7/8	7/8	2.10	2.2	2.50	2.7
<b>C</b>	<b>F</b>	<b>P</b>	<b>L</b>	<b>O.D.</b>		
5/32	13/16	13/32	1 1/16	2.70		