

BALL BEARING HOUSED UNITS

BALL BEARING HOUSED UNITS • CAST-IRON HOUSED UNITS • RSAO, LSAO

RSAO, LSAO HEAVY SERIES

- RSAO pillow blocks are equipped with GN-KRRB wide-inner-ring ball bearings.
- LSAO pillow blocks are equipped with GN-KLLB wide-inner-ring ball bearings.
- All units are suited for installations where the load is heavy in proportion to the shaft diameter or where considerable shock loads exist.
- All units are for use in wet or extremely dirty conditions.
- These units are prelubricated and ready for immediate use. A grease fitting is also provided for relubrication if required.
- All units are supplied with a self-locking collar.

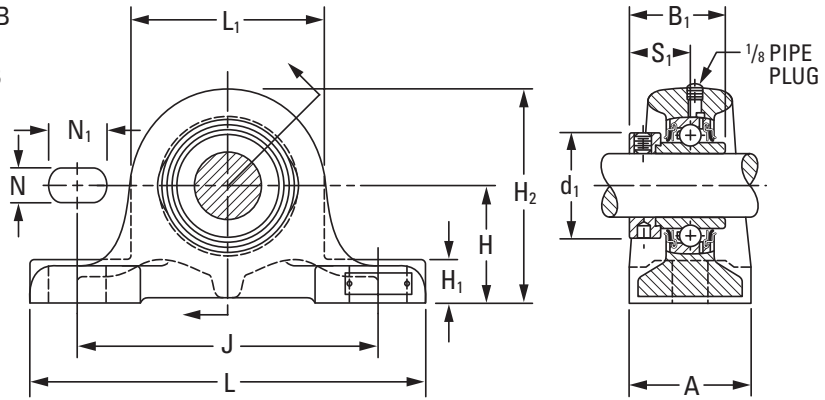

Suggested shaft tolerances:

- 1 1/16 in., nominal to -0.013 mm, -0.0005 in.;
- 2 in. – 3 15/16 in., nominal to -0.025 mm, -0.0010 in.

To order, specify UNIT and SHAFT DIAMETER.

Example: RSAO 1 7/16 in.

BEARING DATA

| Unit | Bearing No. | Dimensions and Load Ratings |
|------|-------------|-----------------------------|
| RSAO | GN-KRRB | Page A-57 |
| LSAO | GN-KLLB | Page A-59 |

| Unit | Shaft Dia. | H | | H ₂ | | B ₁ | | L ₁ | | J | | L | | A | | H ₁ | | N | | N ₁ | | d ₁ | | S ₁ | | Bolt Size | Bearing No. | | Collar No. | Housing No. | Unit Wt. |
|------------|------------|--------|-------|----------------|-------|----------------|-------|----------------|------|------|------|-------|------|-----|------------------|----------------|---------|---------|--------|----------------|----|----------------|----|----------------|----|-----------|-------------|-----|------------|-------------|----------|
| | | in. | mm | in. | mm | in. | mm | in. | mm | in. | mm | in. | mm | in. | mm | in. | mm | in. | mm | in. | mm | in. | mm | in. | mm | | in. | in. | | | |
| RSAO, LSAO | 1 3/16 | 60.33 | 108.0 | 50.0 | 95.2 | 168.3 | 209.6 | 60.3 | 22.2 | 15.9 | 25.4 | 48.7 | 32.5 | 12 | GN103KRRB (KLLB) | SN103K | T-22678 | 2.937 | 6.47 | | | | | | | | | | | | |
| RSAO, LSAO | 1 7/16 | 69.85 | 122.2 | 51.6 | 104.8 | 209.6 | 269.9 | 69.8 | 23.8 | 19.0 | 28.6 | 55.1 | 33.3 | 16 | GN107KRRB (KLLB) | SN107K | T-22496 | 4.154 | 9.15 | | | | | | | | | | | | |
| RSAO, LSAO | 1 1/2 | 79.38 | 136.6 | 57.2 | 114.3 | 228.6 | 288.9 | 79.4 | 27.0 | 19.0 | 28.6 | 63.0 | 37.3 | 16 | GN108KRRB (KLLB) | SN108K | T-22672 | 5.857 | 12.90 | | | | | | | | | | | | |
| RSAO, LSAO | 1 11/16 | 79.38 | 142.9 | 58.7 | 127.0 | 228.6 | 288.9 | 79.4 | 30.2 | 19.0 | 28.6 | 69.3 | 38.9 | 16 | GN111KRRB (KLLB) | SN111K | T-22498 | 6.560 | 14.45 | | | | | | | | | | | | |
| RSAO | 1 3/4 | 79.38 | 148.4 | 66.7 | 138.1 | 228.6 | 288.9 | 79.4 | 33.3 | 19.0 | 28.6 | 75.7 | 42.1 | 16 | GN112KRRB | SN112K | – | – | – | | | | | | | | | | | | |
| RSAO, LSAO | 1 15/16 | 79.38 | 148.4 | 66.7 | 138.1 | 228.6 | 288.9 | 79.4 | 33.3 | 19.0 | 28.6 | 75.7 | 42.1 | 16 | GN115KRRB (KLLB) | SN115K | T-22502 | 7.246 | 15.96 | | | | | | | | | | | | |
| RSAO | 2 | 95.25 | 170.7 | 73.0 | 150.8 | 260.4 | 320.7 | 88.9 | 36.5 | 22.2 | 34.9 | 82.0 | 45.2 | 20 | GN200KRRB | – | SN200K | T-22500 | 10.192 | – | | | | | | | | | | | |
| RSAO, LSAO | 2 3/16 | 95.25 | 170.7 | 73.0 | 150.8 | 260.4 | 320.7 | 88.9 | 36.5 | 22.2 | 34.9 | 82.0 | 45.2 | 20 | GN203KRRB (KLLB) | SN203K | – | – | – | | | | | | | | | | | | |
| RSAO, LSAO | 2 7/16 | 104.78 | 186.5 | 79.4 | 163.5 | 285.8 | 349.2 | 101.6 | 38.1 | 22.2 | 34.9 | 88.4 | 48.4 | 20 | GN207KRRB (KLLB) | SN207K | T-22494 | 16.144 | 35.56 | | | | | | | | | | | | |
| RSAO, LSAO | 2 11/16 | 115.89 | 210.3 | 88.9 | 188.9 | 304.8 | 390.5 | 111.1 | 44.4 | 25.4 | 34.9 | 101.1 | 54.8 | 22 | GN211KRRB (KLLB) | SO211K | T-22492 | 19.295 | 42.50 | | | | | | | | | | | | |
| RSAO, LSAO | 2 15/16 | 115.89 | 217.5 | 100.0 | 203.2 | 314.3 | 390.5 | 111.1 | 47.6 | 25.4 | 34.9 | 112.2 | 62.7 | 22 | GN215KRRB (KLLB) | SN215K | T-22490 | 20.090 | 44.25 | | | | | | | | | | | | |
| RSAO | 3 3/16 | 115.89 | 223.0 | 106.4 | 214.3 | 314.3 | 390.5 | 111.1 | 49.2 | 25.4 | 44.4 | 119.1 | 65.9 | 22 | GN303KRRB | – | SN303K | T-22444 | 22.814 | 50.25 | | | | | | | | | | | |
| RSAO | 3 7/16 | 130.18 | 250.8 | 115.9 | 241.3 | 339.7 | 409.6 | 120.6 | 57.2 | 28.6 | 54.0 | 133.4 | 73.8 | 24 | GN307KRRB | – | SN307K | T-22446 | 30.986 | 68.25 | | | | | | | | | | | |
| RSAO | 3 15/16 | 144.46 | 281.0 | 128.6 | 273.0 | 374.6 | 439.7 | 130.2 | 65.1 | 28.6 | 44.4 | 146.0 | 78.6 | 24 | GN315KRRB | – | SN315K | T-22448 | 40.633 | 89.50 | | | | | | | | | | | |